

LOPEZ / LOPEZB - LED DOWNLIGHTS

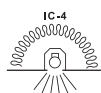
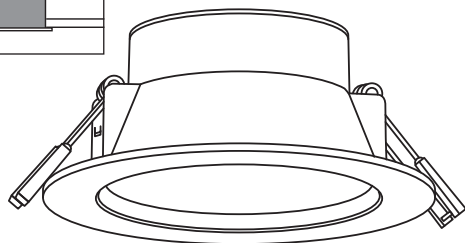
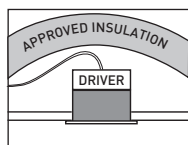

SAFETY

This product complies in full with AS/NZS 60598.2.2.

This product should be installed by a suitably qualified person in accordance with Australian and New Zealand wiring rules.

CLEARANCES FROM COMBUSTIBLE MATERIAL

This luminaire has been independently tested and is rated for IC-4 and IC-F installation.

This product is suitable for use with building insulation that can safely be continually exposed to temperatures up to 90 °C and must withstand a 30s needle flame test carried out in accordance with AS/NZS 60695.11.5, with the flame applied to all surfaces of the sample.

Loose fill insulation as defined in NZS 4246 is not permitted to abut or cover the luminaire.

RISK OF FIRE

Required clearance from structural members and building elements

SCB=0mm MIC=0mm HCIB=0mm SCI=0mm

WARRANTY

The Lopez LED Downlights is guaranteed for 3 years from the date of purchase.

This warranty protects against defects in workmanship and material. Any defects will be rectified by replacement if the goods are returned to place of purchase, with proof of purchase, and with a brief explanation of the experienced fault.

The warranty does not include compensation for any associated expenses involving installation or removal, such as labour or travel.

This warranty becomes null and void if, in our opinion, the product has been misused, tampered with, incorrectly installed, or subjected to power surges.

LOPEZ - SPECIFICATIONS

Rated Operational Voltage	200-240V AC 50Hz
Colour Temperature	3000K / 4000K / 5700K
IP Rating (Front Body)	IP54
IK Rating	IK10
Material	PC
Dimmers	All Vynco Dimmers Compatible with most Clipsal, HPM and PDL trailing edge and C-bus compatible dimmers

Suitable for indoor and outdoor covered areas.
Other specifications such as wattage & lumen output refer to the Lopez range specifications on our website at www.vynco.co.nz

DIMENSIONS

Diameter	Ø 110mm
Cut-Out	Ø 90mm
Depth	47mm

VYNCO INDUSTRIES (NZ) LIMITED

CHRISTCHURCH

388 Tuam Street, Phillipstown, Christchurch, 8011
PO Box 9022, Tower Junction, Christchurch 8149
New Zealand
P +64 3 379 9283
E sales@vynco.co.nz

VYNCO.CO.NZ

AUCKLAND

9 Levene Place, Mount Wellington
PO Box 12 249, Penrose, Auckland 1061
New Zealand
P +64 9 525 6051

LOPEZ / LOPEZB - LED DOWNLIGHT

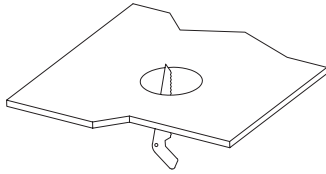

STEP 1

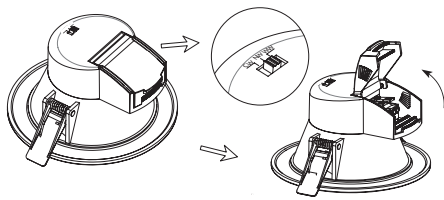

STEP 2

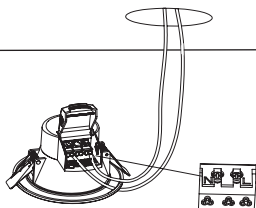

STEP 3

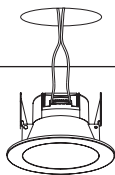

STEP 4

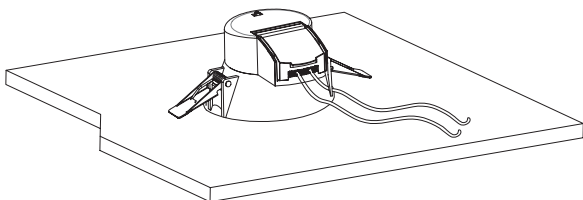

STEP 5

INSTALLATION PROCEDURE

NOTE: This product contains NO user serviceable parts.

WARNING: Ensure the circuit is isolated prior to any work.

STEP 1

Cut a hole in the desired location according to product label.

STEP 2

Open the quick connect terminal cover, ensure the correct colour temperature has been selected with the sliding toggle switch.

STEP 3

Terminate wires, then close the terminal cover and press down lightly.

STEP 4

Hold back the clips as you push the downlight into the cut-out.

STEP 5

Make sure the downlight is fixed correctly in the ceiling, then test the power.

WIRING

L = Phase - Brown

N = Neutral- Blue