

P66FK / P123FK / P126FK - GARCIA LED PANEL FLUSH MOUNT KIT

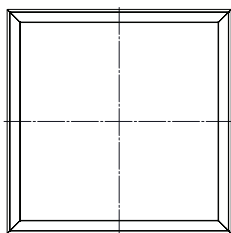

P66FK

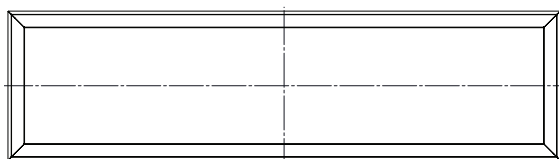

P123FK

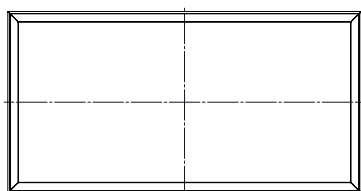

P126FK

CUT OUT DIMENSIONS

P66FK	615 x 615mm
P123FK	1215 x 315mm
P126FK	1215 x 615mm

WARRANTY

This product is covered by the standard 3 Year Vynco Warranty - proof of purchase is required. Please contact Vynco for details of returns procedure.

NOTE: This product contains NO user serviceable parts.

SAFETY

Turn off power before installation or before doing any maintenance work. Do not install any luminaire near a heat source. Take care not to pull any electrical wires during placement and installation.

This product should be installed by a suitably qualified person in accordance with Australian and New Zealand wiring rules.

INSTALLATION PROCEDURE

Prepare rectangular cut-out in the ceiling as per dimensions specified in the table.

STEP 1

A minimum of two long sides of the hole to be framed up with suitable wooden battens.

STEP 2

Insert flush mount frame into prepared hole and secure to timber battens with suitable fasteners.

STEP 3

Wire the LED panel as per the manufacturer's instruction.

STEP 4

Insert the LED panel inside the frame and position the panel so that it looks centered with the flush mount.

STEP 5

Ensure correct wiring/connection before turning on the power.

VYNCO INDUSTRIES (NZ) LIMITED

CHRISTCHURCH

388 Tuam Street, Phillipstown, Christchurch, 8011
PO Box 9022, Tower Junction, Christchurch 8149
New Zealand
P +64 3 379 9283 F +64 3 379 6838
E sales@vynco.co.nz

VYNCO.CO.NZ

AUCKLAND

9 Levene Place, Mount Wellington
PO Box 12 249, Penrose, Auckland 1061
New Zealand
P +64 9 525 6051 F +64 9 525 5799