

INTRODUCING VFT90 RUN ON TIMER

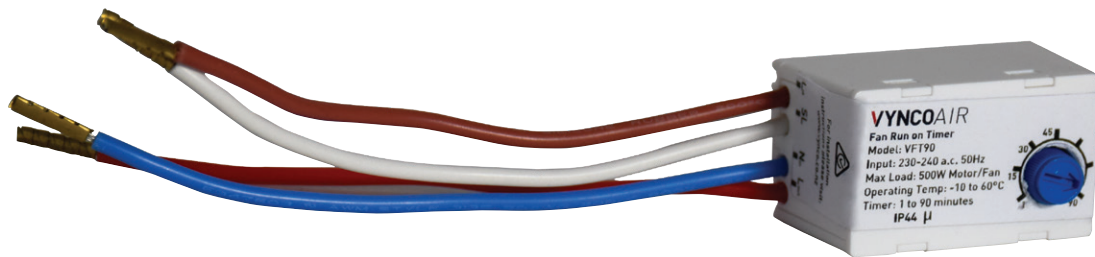

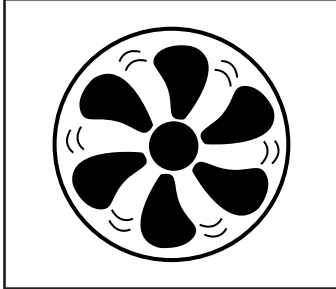

Designed to keep fan operating after room use.

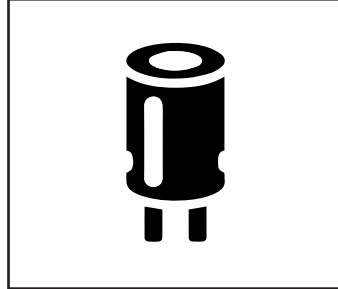

Standard & capacitor start compatible.

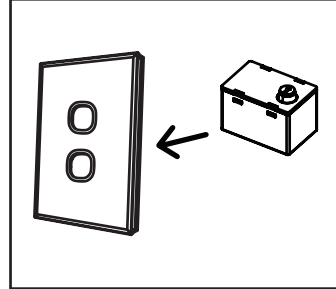

Fits behind standard switchplate.

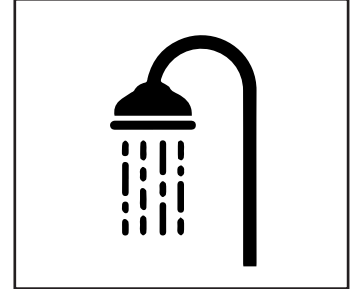

Suitable for toilets and bathrooms.

SPECIFICATIONS

CODE	SUPPLY VOLTAGE	MAXIMUM LOAD RATING	MINIMUM LOAD RATING	OPERATING TEMPERATURE
VFT90	230V-240V a.c. 50Hz.	500W Motor / Fan	0W	-10° to 60°C