

JOLIE/ VE3CR - LED DOWNLIGHT

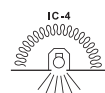
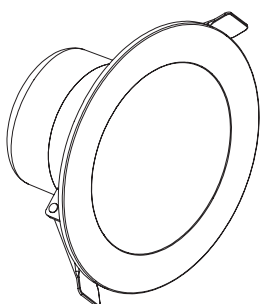
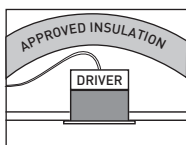

Line drawing is Jolie version

SPECIFICATIONS

Rated Operational Voltage	200-240V AC 50Hz
Colour Temperature	3000K / 4000K / 5700K
IP Rating (Front Body)	IP54
IK Rating	IK10
Material	PC
Dimmers	Recommended: VT1D450LSWE Also compatible with Vynco, Clipsal, HPM and PDL trailing edge and C-bus compatible dimmers

Suitable for indoor and outdoor covered areas. Other specifications such as wattage & lumen output differ across the Jolie range. For individual Jolie specifications, refer to our website at vynco.co.nz.

DIMENSIONS

Diameter	Ø 115mm
Cut-Out	Ø 90-100mm
Depth	64mm

SAFETY

This product complies in full with AS/NZS 60598.2.2:2016.

This product should be installed by a suitably qualified person in accordance with Australian and New Zealand wiring rules.

CLEARANCES FROM COMBUSTIBLE MATERIAL

This luminaire has been independently tested and is rated for IC-4 and IC-F installation.

This product is suitable for use with building insulation that can safely be continually exposed to temperatures up to 90 °C and must withstand a 30s needle flame test carried out in accordance with AS/NZS 60695.11.5, with the flame applied to all surfaces of the sample.

Loose fill insulation as defined in NZS 4246 is not permitted to abut or cover luminaire.

RISK OF FIRE

Required clearance from structural members and building elements

SCB=0mm MIC=0mm HCIB=0mm SCI=0mm

WARRANTY

The Jolie LED Downlights is guaranteed for 3 years from the date of purchase.

This warranty protects against defects in workmanship and material. Any defects will be rectified by replacement if the goods are returned to place of purchase, with proof of purchase, and with a brief explanation of the experienced fault.

The warranty does not include compensation for any associated expenses involving installation or removal, such as labour or travel.

This warranty becomes null and void if, in our opinion, the product has been misused, tampered with, incorrectly installed, or subjected to power surges.

VYNCO INDUSTRIES (NZ) LIMITED

CHRISTCHURCH

388 Tuam Street, Phillipstown, Christchurch, 8011
PO Box 9022, Tower Junction, Christchurch 8149
New Zealand
P +64 3 379 9283 F +64 3 379 6838
E sales@vynco.co.nz

VYNCO.CO.NZ

AUCKLAND

9 Levene Place, Mount Wellington
PO Box 12 249, Penrose, Auckland 1061
New Zealand
P +64 9 525 6051 F +64 9 525 5799

JOLIE/ VE3CR - LED DOWNLIGHT

INSTALLATION PROCEDURE

NOTE: This product contains NO user serviceable parts.

STEP 1

Cut a hole in the desired location according to product label.

STEP 2

Open the quick connect terminal cover, ensure the correct colour temperature has been selected with the sliding toggle switch.

STEP 3

Terminate wires, then close the terminal cover and press down lightly.

STEP 4

Hold back the clips as you push the downlight into the cut-out.

STEP 5

Make sure the downlight is fixed correctly in the ceiling, then test the power.

WIRING

L = Phase - Brown

N = Neutral- Blue

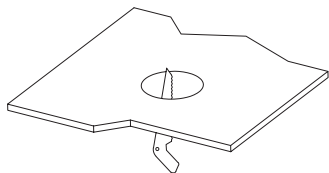

STEP 1

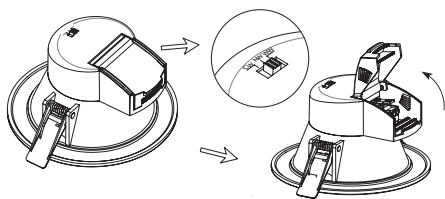

STEP 2

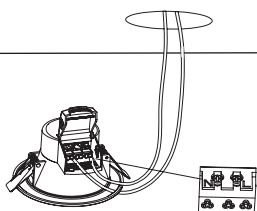

STEP 3

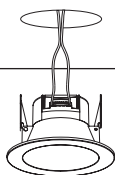

STEP 4

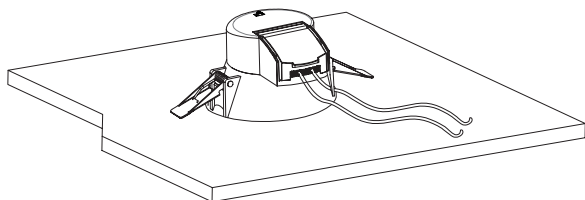

STEP 5