

E1V2 EV Charger User Operating Manual



TABLE OF CONTENTS

CONTENTS	PAGE
Dimensions	4
Carton Contents	4
Operating Instructions	5
Charging Safety Precautions	7
Maintenance	8
Troubleshooting	9
Technical Specifications	10
Servicing, Replacement Parts and Warranty	11

DIMENSIONS

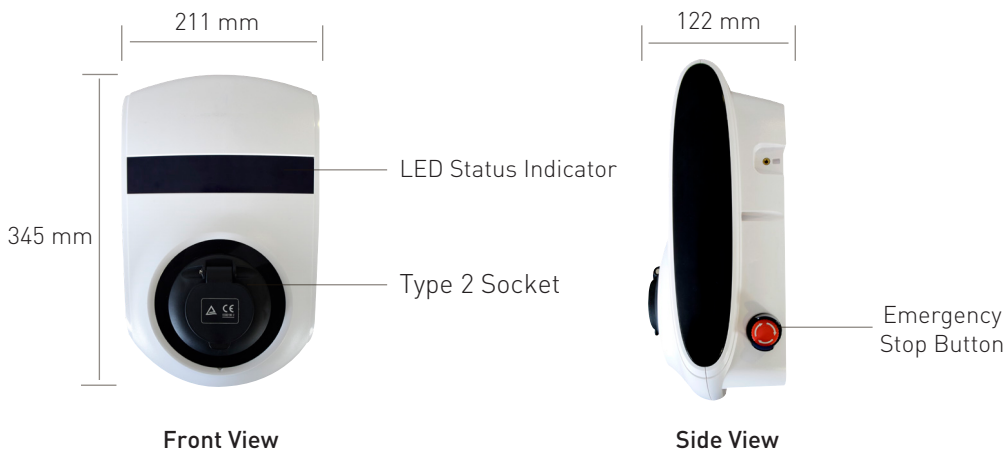

CARTON CONTENTS

The following parts should be inside the carton:

- E1V2 charger
- Black metal mounting plate
- Installation manual
- User operating manual
- Installation screws

If any of the parts are missing or damaged, contact your supplier or Vynco for assistance before installing the charger.

OPERATING INSTRUCTIONS

To start charging your electric vehicle

1. Check the charger is powered. The LED should be blue.
2. Plug the charging lead into your electric vehicle.

Always plug in charging lead into the vehicle first.

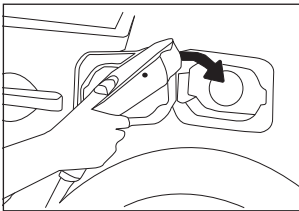

LED STATE	CHARGER STATUS
BLUE	Power Available
GREEN FLASHING	Charging (Normal Operation)
RED FLASHING	Fault or Stop Button pressed in

3. Plug the charging lead into the charger.

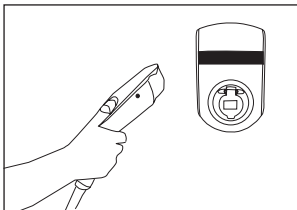

Follow the vehicle manufacturer's instructions to start the vehicle charging. Some vehicles require the doors to be locked or a charging button to be pressed before the charging will start. For most electric vehicles the charging will start automatically after 20 seconds.

4. Check the LED display.

Check if the charger has turned green and is flashing. Check that the status display on the vehicle shows charging.

OPERATING INSTRUCTIONS

To stop charging your electric vehicle

1. Check that the charger is still charging or has finished charging.

If LED is flashing green – vehicle is still charging. The charging can be stopped if required.
If LED is blue – vehicle has finished charging and the battery should be at 100%.

2. Remove the charging lead from the vehicle.

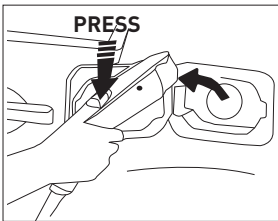

Follow the vehicle manufacturer's instructions to remove the charging lead. Some vehicles require the doors to be unlocked or a charging button to be pressed before the lead can be unlocked and removed.

3. Remove the charging lead from the charger.

If the plug cannot be easily removed from the charger push the plug in firmly and then try to remove the plug again. If the plug will still not come out – push in the red stop button on the side and then try to remove the plug again.

4. Check that the LED status on the charger has turned blue.

The charger is now ready to charge another vehicle. The plug must be removed from the charger each time before you charge a vehicle. This resets the safety protocols built in to the charger. If the LED status is Red – check that the Red Stop Button is out. Twist to release if pushed in.

CHARGING SAFETY PRECAUTIONS

Familiarise yourself with these instructions and the charging instructions for the electric vehicle before using this charger.

- Be careful that the charging leads are not left anywhere where they can get damaged, driven over or create a trip hazard.
- Leave the charging lead in the vehicle or coiled up around the charger when charging is completed.
- Always remove the charging lead from the vehicle first then the charger.
- Do not modify or alter the charger or charging lead in any way.
- Do not use with any extension or adaptor lead.
- Do not join two or more charging leads together.
- Do not use if the charger or charging lead shows signs of damage.
- Only use this charger to charge electric vehicles.
- Do not use to charge or power any other device.
- Do not open up the charger without isolating the power. Caution: Electric shock danger.

MAINTENANCE

The E1V2 electric vehicle charger has been designed to operate under normal working conditions and usually does not require any special maintenance during its lifetime. Vynco recommends the following checks to ensure the long term operation of the charger and safety of the users.

INTERVAL	MAINTENANCE	ACTION
At every charge	Visual check that the housing is not damaged, cracked or broken.	If the housing is damaged, contact your installer for a safety check before using.
	Check that the blue LED light is on.	Check that the power is on to the charger - Isolator is turned on. - Check that the MCB and RCCB at the switchboard are both on (levers up).
Every 6 months	Clean the charger with a damp cloth (not wet) to remove any dirt, grime and cob-webs.	Do not use cleaning agents or solvents to clean the charger as these may damage the plastic housing.
	Press the red stop button on the side and check that the RED Light comes on and flashes. Twist to release the Stop Button after testing.	Do not use the charger if the red light does not come on. Contact your installer for a safety check.
Yearly	Press the test button on the RCCB at the switchboard.	The RCCB should trip and disconnect the power to the Charger. DO-NOT use the charger if the RCCB does not trip. Contact your installer for a safety check.
	Commercial installations may require that the charger is tested and tagged every 12 months.	See the Worksafe NZ EV Charging Safety Guidelines for details or contact your Installer.

TROUBLESHOOTING

ERROR	CAUSE	SOLUTION	
No LED lights on display	No power available	Check if the MCB and RCCB at the switchboard is ON or Isolator is turned ON.	
Flashing Red Display	Emergency Stop button pushed in	Twist stop button to release.	
	Faulty charging cable	Use another cable to check charger.	
Flashing Green Display	Earth fault in car or lead	Contact your installer.	
	Vehicle Charging	Normal operation during charging – no action required.	
Blue Display	Power available		
Vehicle not charging	Power not on	Check LED display is on and turn power on if required.	
	Plug fitted incorrectly	Ensure plug is pushed in to Charger.	
	Connector fitted incorrectly	Ensure connector is pushed in to the vehicle inlet.	
	Vehicle not detecting plug	Always plug into vehicle first then charger.	
	Vehicle charging system not turned on	Check vehicle manual for charging instructions – lock vehicle doors or push charging button on vehicle.	
Charging cable cannot be removed from charger or vehicle	Fault in charging cable	Try another cable, check cable and plugs for damage.	
	Interlocks in vehicle and charger engaged	Turn vehicle charging button off or unlock vehicle if required.	
		Always unplug vehicle first then charger.	
	Charging takes a while to start	Charger checking the safety systems before charging. This check can take 20 secs	Normal operation. Charging will start after 20 secs when safety checks are complete.
		Charger not detecting the lead and vehicle	Unplug the lead from the charger and plug in again to reset. Always plug in vehicle first then charger.

TECHNICAL SPECIFICATIONS - E1V2

Electrical Ratings	Rated Input Voltage	230V a.c. +- 10% - Single Phase
	Frequency	50Hz
	Maximum Power	7.4kW
	Rated Current	32A maximum (permanent connection)
	Standby Power	<6W
Electrical Protection	RCCB Protection	None supplied – Type B RCCB required to be fitted at the switchboard RCCB - minimum 32A – 2 Pole.
	Additional Internal Protection	Under/Over Voltage, Short Circuit, Under/Over Temperature, Phase Protection
	Equipment Protection Class	Class 1
Environmental Ratings	Suitable For Use	Indoors or Outdoors. Restricted access location
	Protection Rating	IP54
	Working Temperature Range	-30°C to +55°C
	Working Humidity	5% to 95% without condensation
	Maximum Elevation	<2000 Metres
	Average Mean Time Before Failure (MTBF)	100,000 operations
	Overall Dimensions	211mm x 345mm x 122mm (L x W x D)
	Installation	Surface, wall or post mount (post not provided)
Operational Ratings	Weight	< 4.0kgs
	Activation method	Plug in and charging starts automatically after 20 seconds
	Emergency Disconnection	Emergency Stop Button
	LED Status Indication	Blue – Power Available. Green Flashing – Charging. Red Flashing – Fault.
Compliance	Charging Method	Mode 3
	Electrical Standards complying to	IEC 61851-1:2017, IEC 61851-23 (Mode 3)
Instructions	Supplier Declaration of Conformity (SDoC)	Available from - www.vynco.co.nz
	Installation and Operating instructions.	Available from - www.vynco.co.nz

SERVICING, REPLACEMENT PARTS & WARRANTY

Servicing:

The E1V2 Electric Vehicle Charger does not contain any user serviceable parts. If your charger stops working or has broken parts contact your installer or Vynco for assistance.

Replacement Parts:

Only Vynco supplied replacement parts can be used to repair this electric vehicle charger. Contact your installer or Vynco for assistance.

Warranty:

This product is covered by the standard 3 year Vynco Warranty - proof of purchase is required.

Please contact Vynco for details of returns procedure.

All contents and diagrams contained in this manual are copyrighted and are not to be reproduced in any form without written permission of Vynco Industries Ltd.



Christchurch Office

388-396 Tuam Street, Phillipstown, Christchurch 8011
PO Box 9022, Tower Junction, Christchurch 8149
P (+64) 3 379 9283 F (+64) 3 379 6838
E sales@vynco.co.nz

Auckland Office

9 Levene Place, Mt Wellington, Auckland 1061
PO Box 12 249, Penrose, Auckland 1642
P (+64) 9 525 6051 F (+64) 9 525 5799
E sales@vynco.co.nz