

MOORE UNDER VERANDA BATTEN

SUITABLE FOR CEILING AND WALL MOUNTING OR SUSPENDING

SAFETY INFORMATION:

To ensure correct function and safety, please read and follow all instructions carefully before using the product:

- Turn off power before installation or before doing any maintenance work.
- Do not install any luminaire near a heat source.
- Do not exceed the nominal supply voltage or amperage ratings.
- Take care not to pull any electrical wires during unpacking as this may damage the connection.
- Lay out all the components on a smooth surface and make sure there are no components missing before assembling.
- To avoid injury or damage to the fitting, please ensure that power leads and screws are secure before connecting the power.
- All wiring and installation of the light fitting must adhere to AS/NZS 3000 Wiring Rules.

INSTALLATION INSTRUCTIONS:

- Switch off before installation.
- Switch on only after complete installation and examination of the circuit.
- Installation and maintenance should only be completed by a registered electrician.

Turn off power supply before starting any installation. Read instructions & check you have all the tools & accessories to complete the installation correctly.

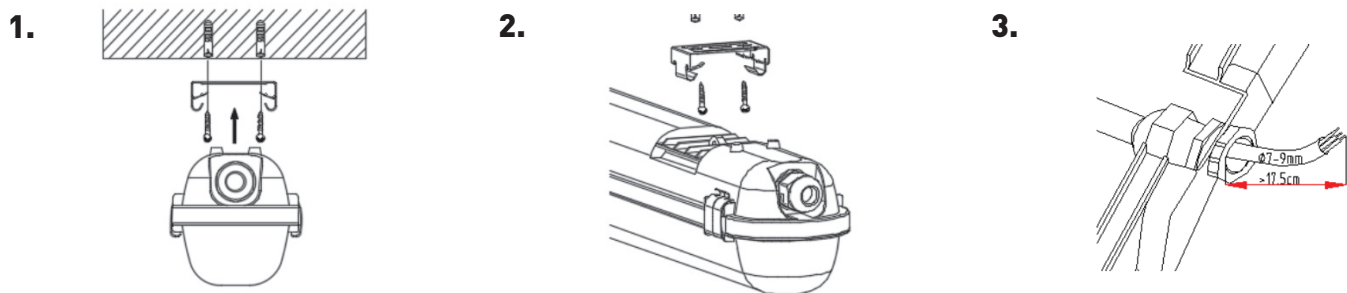

1. Place the surface mount metal clip to the position of where the light is being installed. Install the metal clip using the wall plug and the 2 self-tapping screws provided.

2. Push the PC grey base onto the mounted clips. Clips must match the mounting points on the light fitting.

3. Insert the Mains through the side entry gland. Tighten the screw after feeding the cable through to the terminal block.

Vynco Industries (NZ) Limited Christchurch Office

388 Tuam Street, Phillipstown, Christchurch, 8011
PO Box 9022, Tower Junction, Christchurch 8149
New Zealand
P +64 3 379 9283 F +64 3 379 6838
E sales@vynco.co.nz
www.vynco.co.nz

Auckland Office

9 Levene Pl, Mount Wellington
PO Box 12 249, Penrose, Auckland 1061
New Zealand
P +64 9 525 6051 F +64 9 525 5799
E sales@vynco.co.nz
www.vynco.co.nz

MOORE UNDER VERANDA BATTEN

SUITABLE FOR CEILING AND WALL MOUNTING OR SUSPENDING

INSTALLATION INSTRUCTIONS CONTINUED:

4.



4. Strip 8mm of cable before connecting into the terminal block. Connect L (Phase) to L, N (Neutral) to N, and Green/Yellow (Earth) to \oplus .

5.

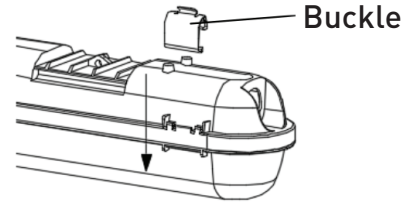

5. Clip the PC Opal Diffuser (Lens) onto the light using the locking clips.

WARRANTY:

This product is covered by the standard 3 year Vynco Warranty - proof of purchase is required.

Please contact Vynco for details of returns procedure.

NOTE: This product contains NO user serviceable parts.

Vynco Industries (NZ) Limited

Christchurch Office

388 Tuam Street, Phillipstown, Christchurch, 8011

PO Box 9022, Tower Junction, Christchurch 8149

New Zealand

P +64 3 379 9283 F +64 3 379 6838

E sales@vynco.co.nz

www.vynco.co.nz

Auckland Office

9 Levene Pl, Mount Wellington

PO Box 12 249, Penrose, Auckland 1061

New Zealand

P +64 9 525 6051 F +64 9 525 5799

E sales@vynco.co.nz

www.vynco.co.nz