

VEF2B / VEF2W / VEF2G - MAGNUM ARCHITECTURAL EXTERNAL FAN + GRILLE

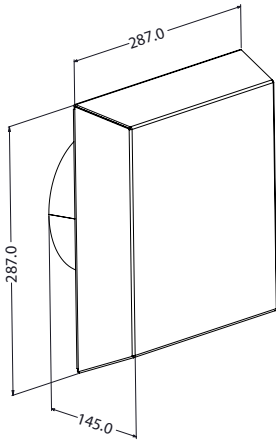

SAFETY

Appliance not intended for use by persons (including children) with reduced physical, sensory or mental capabilities, or lack of experience and knowledge, unless they have been given supervision or instruction concerning use of appliance by person responsible for their safety.

Children should be supervised to ensure they do not play with appliance.

Ensure that the fan is switched off from supply mains before moving the guard.

Precautions must be taken to avoid back flow of gasses into room from open flue of gas or other fuel burning appliances (for duct and partition fans).

If supply cord is damaged, it must be replaced by the manufacturer, its service agent or similarly qualified persons in order to avoid a hazard.

FITTING

Body components made from powdercoated aluminium construction. Accepts standard 150mm ducting. Supplied with terminal box and motor capacitor.

Available in:

VEF2W - External Extractor Fan with White Grille

VEF2B - External Extractor Fan with Black Grille

VEF2G - External Extractor Fan with Grey Grille

SPECIFICATIONS

Input Voltage	220 - 240V AC
Power	59W
Duct Size	150mm
Number of Blades	7

WARRANTY

This product is covered by the standard 5 Year Vynco Warranty - proof of purchase is required. Please contact Vynco for details of returns procedure.

NOTE: This product contains NO user serviceable parts.

VYNCO INDUSTRIES (NZ) LIMITED

CHRISTCHURCH

388 Tuam Street, Phillipstown, Christchurch, 8011
 PO Box 9022, Tower Junction, Christchurch 8149
 New Zealand
 P +64 3 379 9283
 E sales@vynco.co.nz

VYNCO.CO.NZ

AUCKLAND

9 Levene Place, Mount Wellington
 PO Box 12 249, Penrose, Auckland 1061
 New Zealand
 P +64 9 525 6051

VEF2B / VEF2W / VEF2G - MAGNUM ARCHITECTURAL EXTERNAL FAN + GRILLE

WIRING DIAGRAM

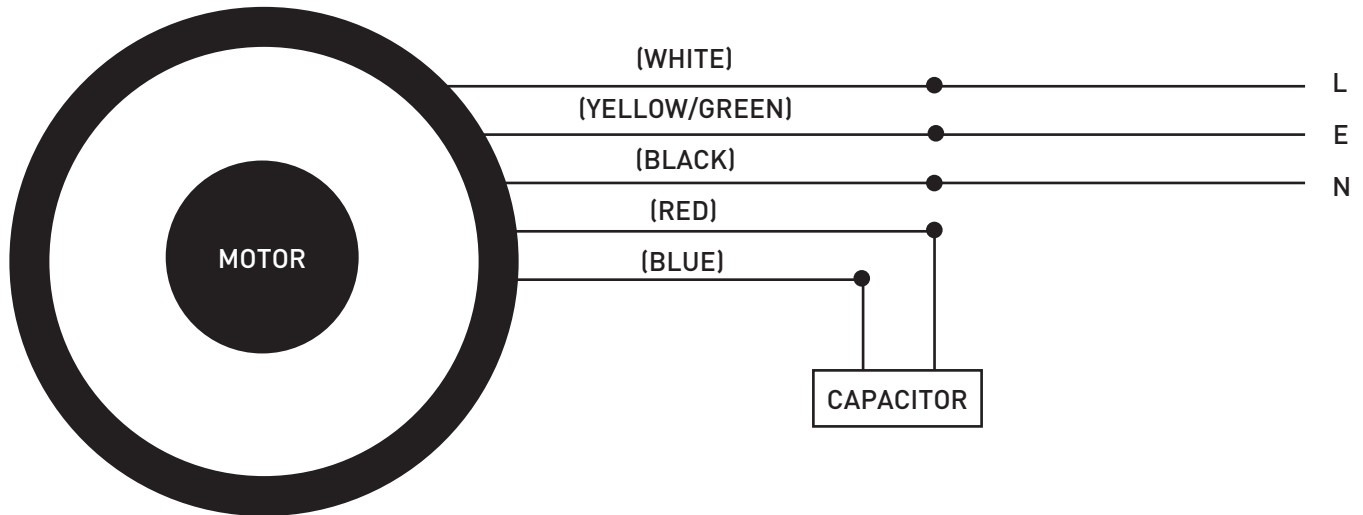

INSTALLATION PROCEDURE

STEP 1

Loosen the 4 x M6 cover screws holding on the cover and remove the cover by sliding it off the fan base assembly.

STEP 2

Make a hole cut-out on the mounting surface that can accommodate spigot and electrical supply cable.

STEP 3

From the above wiring diagram, wire fan and capacitor inside to the terminal box.

STEP 4

Securely seal the ducting to the spigot.

STEP 5

Mount the fan base assembly to the wall or soffit. Ensure terminal box and duct are placed inside the cut-out.

STEP 6

Ensure the fan is level before tightening screws.

STEP 7

Reinstall cover to the fan base assembly by securing 4 x M6 cover screws on both sides.