

XLM SERIES & XLU SERIES METRO/URBAN OUTDOOR LED LIGHTING

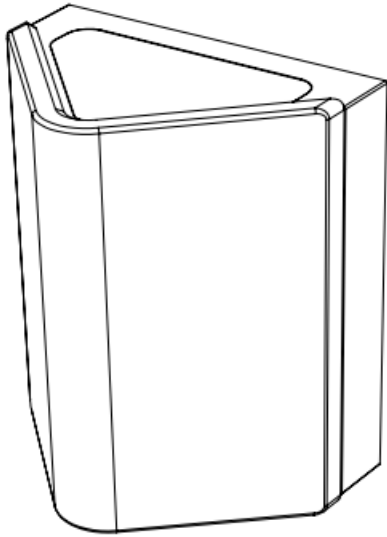

Allow suitable ventilation around the fitting and do not cover with any material.

Do not fully or partially submerge this product in water. This product should be installed by a suitably qualified person in accordance with Australian and New Zealand wiring rules AS/NZS 3000.

CLEANING INSTRUCTIONS

This product shall be cleaned with a damp cloth only, no cleaning agents or solvents to be used. Failure to follow these instructions will void warranty offer.

WARRANTY

The warranty protects against defects in workmanship and material. Any defects will be rectified by replacement if the goods are returned to place of purchase, with proof of purchase, and with a brief explanation of the experienced fault.

The warranty does not include compensation for any associated expenses involving installations or removal, such as labour or travel.

The warranty becomes null and void if, in our opinion, the product has been misused, tampered with, incorrectly installed, or subjected to power surges.

PRODUCT SIZING & MOUNTING DETAILS

NOTE: Before installation, ensure that all mounting locations are suitable and mounting surfaces are of a suitable material.

PRECAUTION: Use only neutral cure sealant that is suitable for use with plastic/polycarbonate (PC)

PRODUCT & TECHNICAL SPECIFICATIONS

Rated Operational Voltage	220-240V AC
Lumen Outputs (Single or Dual Direction)	Single = 1x 4W: 500lms Dual = 2x 4W: 500lms (1000lms total)
Dimmable	No
Colour Temperature	3000K
IP Rating (Body)	IP65
Safety	Class II
Suitable for indoor & exposed outdoor use. For all other specifications for the METRO/URBAN Outdoor LED Lighting range, refer to our website, www.vynco.co.nz	

SAFETY

Please read all instructions prior to installation of this product.

This product complies in full with the **AS/NZ 60598** standard.

Always ensure power is switched off/isolated on circuit before installation, internal cleaning or maintenance.

Do not attempt to modify this fitting in any way.

PRODUCT SIZING – ALL MODELS

Height (mm)	108
Width (mm)	94
Depth (mm)	66

VYNCO INDUSTRIES (NZ) LIMITED

CHRISTCHURCH

388 Tuam Street, Phillipstown, Christchurch, 8011
PO Box 9022, Tower Junction, Christchurch 8149
New Zealand
P +64 3 379 9283

E sales@vynco.co.nz

VYNCO.CO.NZ

AUCKLAND

9 Levene Place, Mount Wellington
PO Box 12 249, Penrose, Auckland 1061
New Zealand
P +64 9 525 6051

XLM SERIES & XLU SERIES METRO/URBAN OUTDOOR LED LIGHTING

MOUNTING DETAILS – ALL MODELS

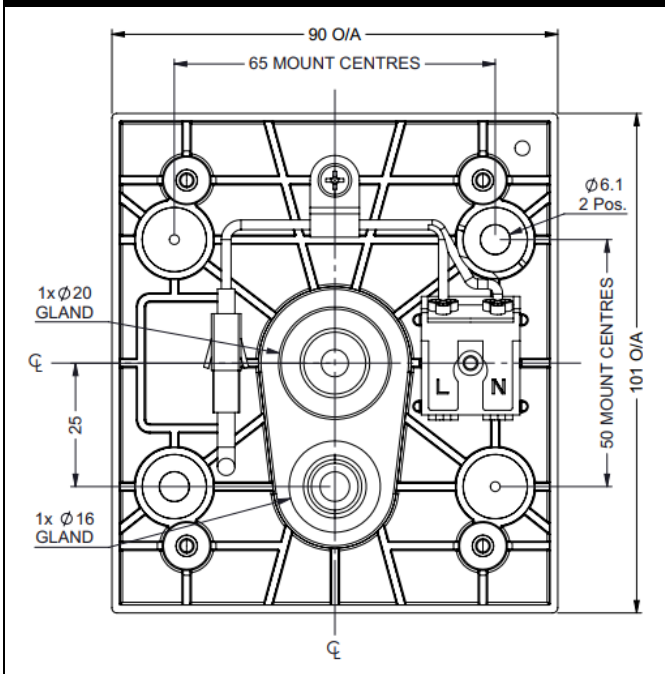

NOTE: Mounting base is symmetrical and can be mounted up or down during installation

INSTALLATION INSTRUCTIONS

WARNING: Ensure the circuit is isolated prior to any work

NOTE: This product contains NO user serviceable parts.

STEP 1: Turn off or isolate any relevant power supply before installation or maintenance work.

STEP 2: Unclip & remove the top cover from the fitting. Set aside carefully to avoid damage.

STEP 3: Unscrew the 4x fixing screws to separate the body & mounting base. Unplug the quick connect plug inside to separate the body & base units.

STEP 4: If not already complete, use the mounting base to mark the position of the cable entry and/or screw holes on the mounting surface.

STEP 5: Use appropriate techniques & fasteners to drill & insert fasteners into the mounting surface.

STEP 6: Push the power supply through the gland on the base. Use appropriate techniques to maintain the required IP rating.

Secure the base to the mounting surface using the appropriate seals & screws.

STEP 7: Terminate the power supply cables to the terminal block fixed on the mounting base. Ensure excess cable is pushed back through the gland neatly if required.

WIRING

L = Phase	Brown or Red
N = Neutral	Blue or Black

STEP 8: Reconnect the Quick Connect plug for the body to base connection.

STEP 9: Reinstall the body onto the fixed base assembly. Secure in place the 4x mounting screws. Ensure no cables or fittings get clamped or crimped during install.

STEP 10: Reinstall the top cover to the body ensuring all clips are engaged correctly.

STEP 11: Turn on or energise the power supply and test the circuit as required.

DISCLAIMER

Specifications are subject to change without notice

VYNCO INDUSTRIES (NZ) LIMITED

CHRISTCHURCH

388 Tuam Street, Phillipstown, Christchurch, 8011
PO Box 9022, Tower Junction, Christchurch 8149
New Zealand
P +64 3 379 9283

E sales@vynco.co.nz

VYNCO.CO.NZ

AUCKLAND

9 Levene Place, Mount Wellington
PO Box 12 249, Penrose, Auckland 1061
New Zealand
P +64 9 525 6051