

MOORE5 - 5FT SINGLE COLOUR UNDERVERANDAH

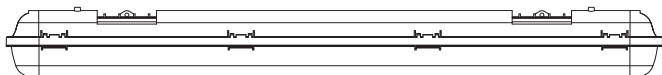

SAFETY

Turn off power before installation or before doing any maintenance work. Do not install any luminaire near a heat source.

Do not exceed the nominal supply voltage or amperage ratings. Take care not to pull any electrical wires during unpacking as this may damage the connection.

Lay out all the components on a smooth surface and make sure there are no components missing before assembling.

To avoid injury or damage to the fitting, please ensure that power leads and screws are secure before connecting the power.

This product complies in full with AS/NZS 3000. This product should be installed by a suitably qualified person in accordance with Australian and New Zealand wiring rules.

WARRANTY

This product is covered by the standard 3 Year Vynco Warranty - proof of purchase is required. Please contact Vynco for details of returns procedure.

NOTE: This product contains NO user serviceable parts.

SPECIFICATIONS

Input Voltage	220 - 240V AC
Colour Temperature	4000K
IP Rating	IP65
IK Rating	IK08
LED Lifetime Hours	50,000
Material	PC Body + PC Opal Cover

DIMENSIONS

Length	1575mm
Width	104mm
Depth	73mm

VYNCO INDUSTRIES (NZ) LIMITED

CHRISTCHURCH

388 Tuam Street, Phillipstown, Christchurch, 8011
PO Box 9022, Tower Junction, Christchurch 8149
New Zealand
P +64 3 379 9283 F +64 3 379 6838
E sales@vynco.co.nz

VYNCO.CO.NZ

AUCKLAND

9 Levene Place, Mount Wellington
PO Box 12 249, Penrose, Auckland 1061
New Zealand
P +64 9 525 6051 F +64 9 525 5799

MOORE5 - 5FT SINGLE COLOUR UNDERVERANDAH

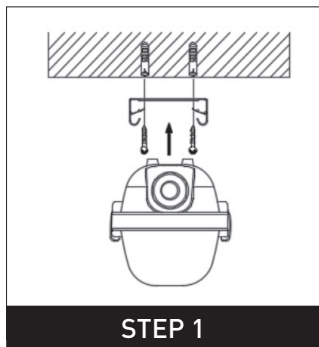

STEP 1

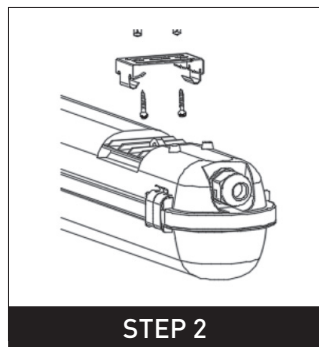

STEP 2

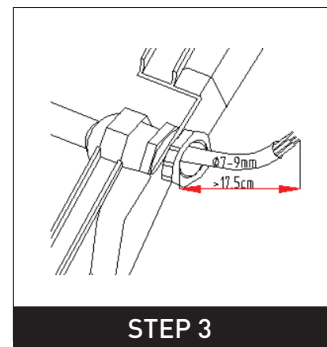

STEP 3

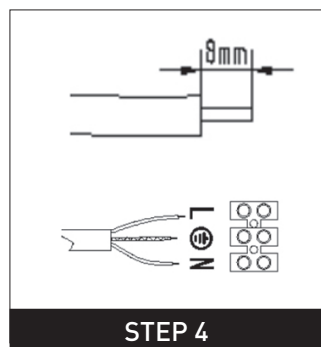

STEP 4

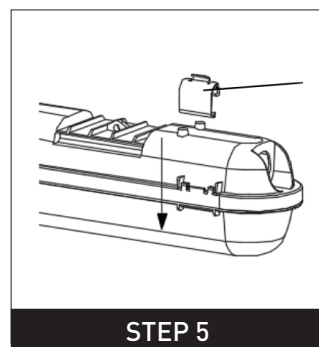

STEP 5

INSTALLATION PROCEDURE

Switch off before installation. Switch on only after complete installation and examination of the circuit. Installation and maintenance should only be completed by a registered electrician.

STEP 1

Place the surface mount metal clip in position where the light is being installed. Install the metal clip using the wall plug and the 2 self-tapping screws provided.

STEP 2

Push the PC grey base onto the mounted clips. Clips must match the mounting points on the light fitting.

STEP 3

Insert the mains through the side entry gland. Tighten the screw after feeding the cable through to the terminal block.

STEP 4

Strip 8mm of cable before connecting into the terminal block. Connect L (Phase) to L, N (Neutral) to N, and Green/Yellow (Earth) to \oplus .

STEP 5

Clip the PC Opal Diffuser (Lens) onto the light using the locking clips.